

bowtiev.com



a new definition for future proof broadcasting...

Unit 1

High Definition

Outside Broadcast Production Vehicle



Unit 1 - Specification

Vehicle Details

Registration mark	10B
Travelling dimensions	9.6m long x 2.4m wide x 3.7m high
Working dimensions	10.5m long x 4.4m wide x 3.7m high
Weight	13 Tonnes.
Power Input	63A, 3 phase. (380/415V) EN60309 3P+N+E connector. 125A, 1 phase. (220/250V) EN60309 1P+N+E connector. Average load, 70A distributed across 3 phases
HVAC	Separate air conditioning or heating for production, sound and vision/VTR

Technical details – Production

Monitor stack	8 x 14" CRT preview monitors 34 x 10" CRT preview monitors 2 x 24" CRT HD transmission and preview monitors
Vision mixer panel	Sony MVS 8000 3ME panel (2.5ME available) 24 crosspoint buttons per row.
Additional features	Matrix panels inset into desk for iso switching etc. Full 5.1 audio monitoring Matrix panels in rear production desk for iso switching etc

Technical details – Sound

Sound mixer	Calrec Zeta digital mixer; 40 fader frame; DSP for 42 stereo and 24 mono channels; 32 stereo AES inputs 32 stereo AES outputs 64 mono mic/line inputs 64 mono line outputs 128 mono via 2 xMADI inputs 128 mono via 2 xMADI outputs
Multichannel encoding	2 x Dolby D encoders
Multichannel decoding	1 x Dolby 562 decoder
Grams playback/record	360 Systems shortcut; Sony CD player; Sony MiniDisc player/recorders; 2 x Marantz flash card player/recorders
Monitoring	Genelec 1029 (L,C,R,Ls, Rs) Genelec 7050 sub
Audio matrix	Harris Integrator 64 ² AES matrix
Communications	Trilogy Orator 36 ² digital matrix
Radio comms	2 x Key duplex base stations, GP300 handsets
Hard wired comms	RTS dual 2–4 wire converter & PSU
Outboard processing	2 x 7000 series Bel Digital Delay units, 1 x SPX 1000 reverb unit, 2 x Sonifex Digital TBU's

Unit 1 - Specification

Technical details – Vision

Cameras	10 x Thomson GrassValley LDK-6000 Mk2 Worldcam HD/SD cameras System 9000 control bus with MCP
Monitoring	16 preview monitors 2 x JVC HD/SD 17" CRT monitor
Vision mixer	Sony MVS-8000ASF HD or SD switcher 2.5 M/E 8 Frame/clip store outputs capable of recording 34 Inputs Freely configurable Aux and ME outputs across 24 physical outputs
Video effects	Sony MVE-8000 HD or SD effects 2 channel (up to 4 channel) Fully integrated with MVS-8000 switcher
Video matrix	Harris Integrator Gold 128 ² wideband crosspoints
Synchronisers	1 x Harris X-75 multi-path up/down/cross converter & synchroniser with audio processing 2 x Harris X-75 multi-path SD synchroniser 3 x SD-SDI synchroniser 3 x analogue – SD-SDI converter/synchroniser
Additional features	TSL Tallyman UMD and tally controller Ample space for graphics devices 2 x HD/SD embedded transmission lines

Technical details – VTR

Capacity	10 x HD or SD VTR of which, up to 3 x HD or SD EVS LSM
Monitoring	15 preview monitors 2 x 14" Sony CRT monitors 2 x CTP systems VTR audio monitoring units
Additional features	4 x DVD recorders

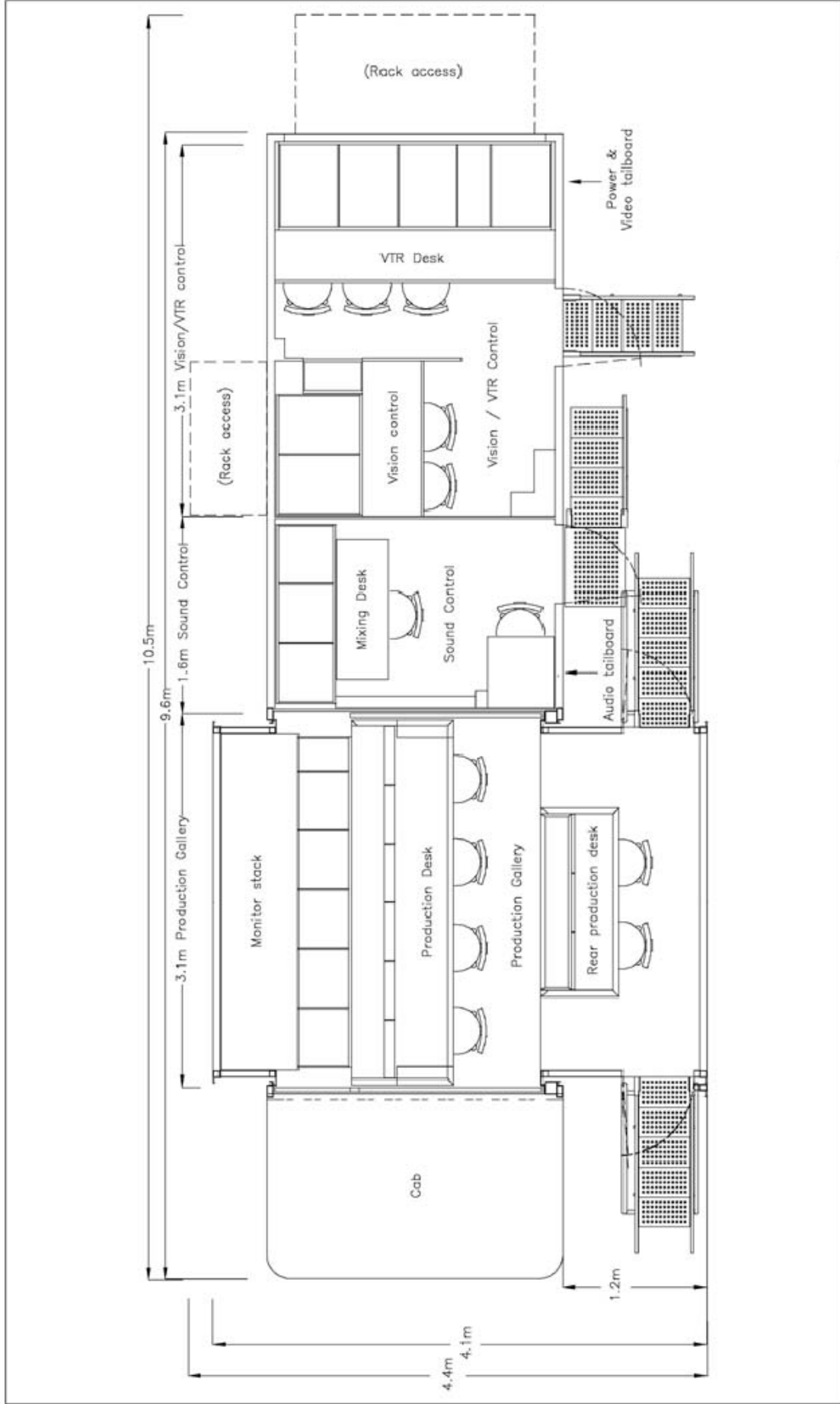

Bow Tie television
 Tel : +44 8454 900 900
 info@bowtietv.com
 www.bowtietv.com

**Unit 1
 Technical
 floorplan**

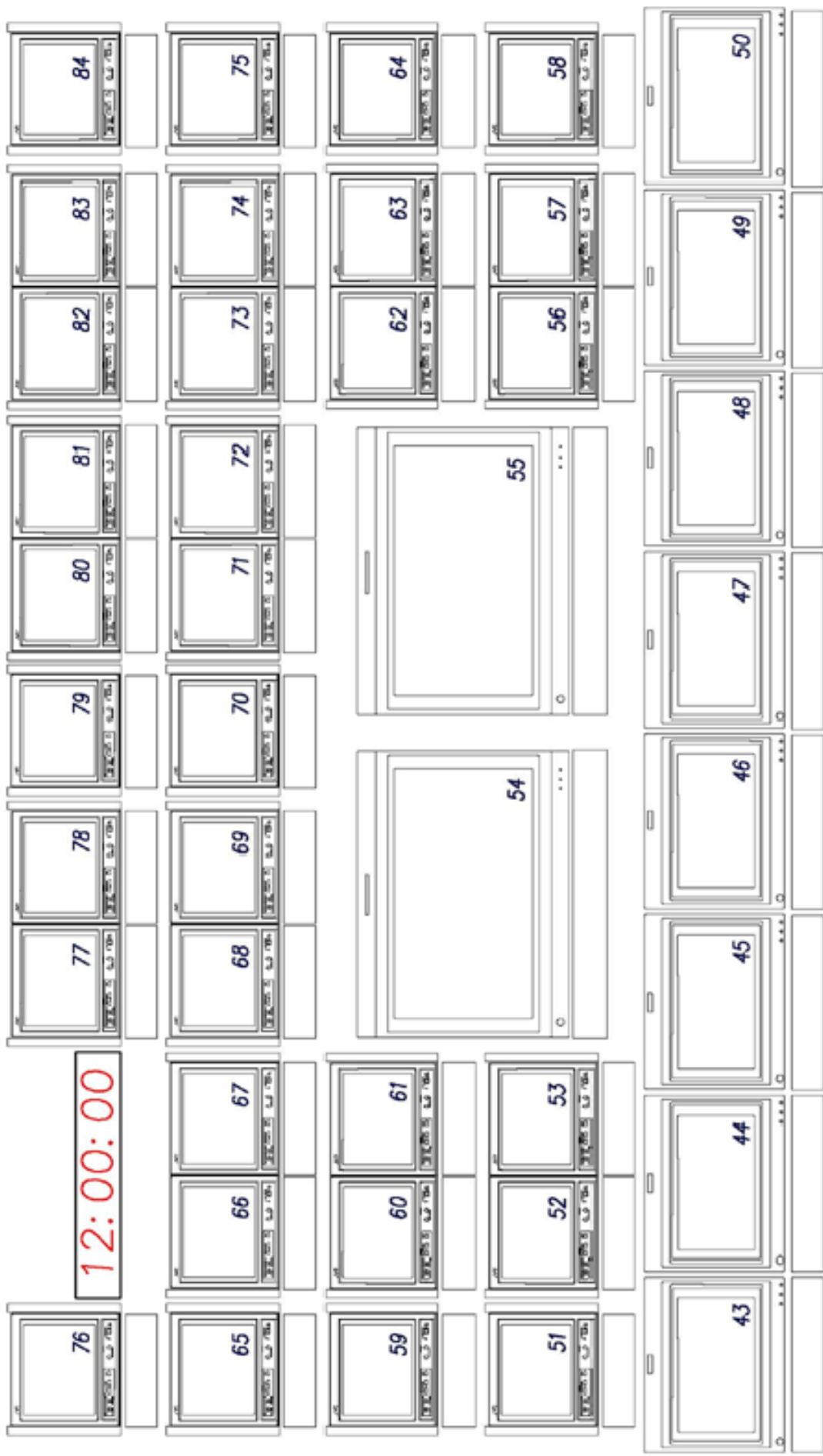

Unit 1 production monitor wall



Unit 1 - Layout

